

PHILIPS

EasyKey

1000 series

Indoor lock

DDL101-3HBS

User manual

www.philips.com/support

Sign your product up and get support at www.philips.com/support



Contents

1. Important Information	02	6. Indicators	16
Safety			
Caution			
Disposal of used products and batteries			
<hr/>		7. Troubleshooting	16
2. Assembly	03	Low battery alert	
Packing list		Lock-out alert	
Exploded views		Battery replacement	
Notice before assembling		How to apply external power supply	
Assembly procedures			
<hr/>			
3. Get to know your lock	08		
Exterior unit			
Interior unit			
<hr/>			
4. Settings	09		
Initialization			
Fingerprint			
Lock mode			
Mute mode			
Default settings			
Application binding			
<hr/>			
5. Get to use your lock	15		
Outdoor/ indoor unlock			
Outdoor/ indoor locking			

1. Important information

Safety

- ◆ Before using this product, please read and understand all instructions. Damage caused by failure to follow the instructions is not covered by the warranty.
- ◆ Use only the accessories/components specified by the manufacturer.
- ◆ Please use alkaline batteries or lithium polymer batteries that are specifically recommended for this product, or use batteries of the same specifications and type.
- ◆ Do not forcibly disassemble the product to trigger an alarm or damage the product.
- ◆ Do not scrape the fingerprint sensor with sharp objects, as this may cause permanent damage.
- ◆ Do not expose products to places that have water leakage or splashing.
- ◆ Do not expose the product to corrosive substances to prevent damaging the protective cover.
- ◆ Do not hang objects on the handle in case it might affect the use of the lock.
- ◆ Please use a soft cloth soaked in water to remove fingerprints/dirt left on the surface of the assembly.
- ◆ Do not remove the batteries during setting up and operating.
- ◆ Please follow the assembly instructions to install the product and keep the relevant sealed stickers properly.
- ◆ Please change the default master PIN code immediately after completing the installation and troubleshooting, properly store the mechanical keys, and do not disclose the PIN codes to others.
- ◆ Please replace all batteries immediately when a low battery alarm appears.

Caution

- ◆ Do not place the batteries near ignition source to avoid explosion.
- ◆ Do not use any power supply that does not meet the safety requirements to power up the product.
- ◆ Do not connect the 2 poles of the batteries to metals to avoid a short circuit that may cause an explosion.
- ◆ Please make sure installation or any component replacement is performed by Philips, a Philips authorized service center or professional technicians.
- ◆ Do not use accessories or parts manufactured by others or not expressly recommended by Philips. The use of such accessories and parts may void the warranty.

Disposal of used products and batteries

- ◆ You can have your locks taken back at authorized Philips service centers. You will receive appropriate compensation if your products meet our conditions.
- ◆ Please familiarize yourself with the local collection system for electronic products.
- ◆ Please follow local regulations and do not discard used products and batteries into ordinary household waste.
- ◆ Please familiarize yourself with the local regulations for recycling batteries. Proper disposal of batteries can help prevent negative effects on the environment and human health.

2 Assembly

Packing list

This packing list is for reference only. Please refer to the actual packing items.

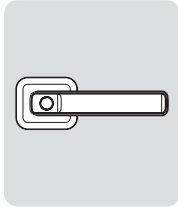

① Exterior unit

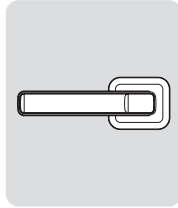

② Interior unit

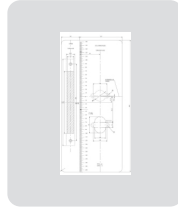

③ Drilling template

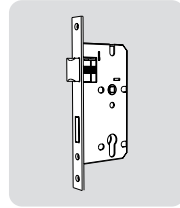

④ Mortise

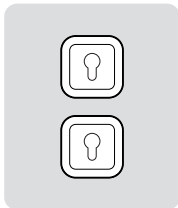

⑤ Lock cylinder cover



⑥ User manual

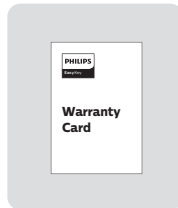

⑦ Warranty card

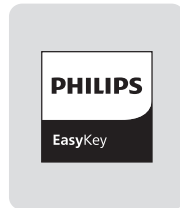

⑧ Quality certificate

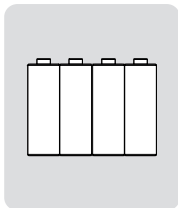

⑨ AAA batteries

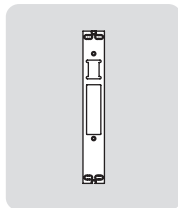

⑩ Strike plate

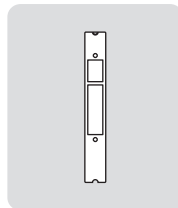

⑪ Strike box

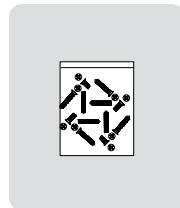

⑫ Installation kit

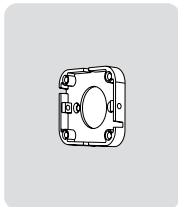

⑬ Interior unit base

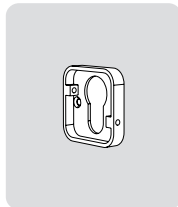

⑭ Interior lock cylinder cover base

Exploded views

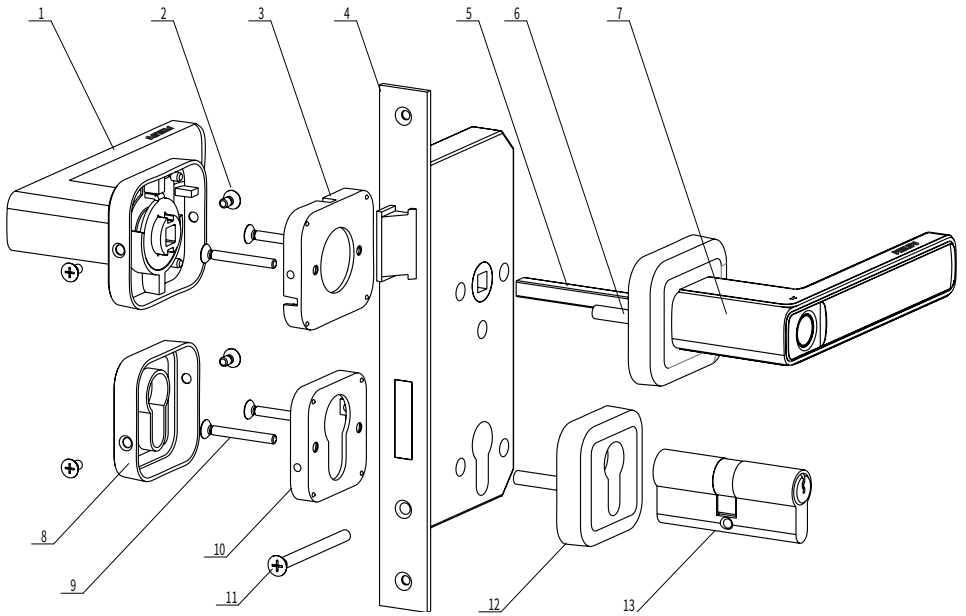

1. Interior unit x1

2. Lateral screw x4

3. Interior unit base x1

4. Mortise x1

5. Hollow square shaft x1

6. M5 screw tube x4

7. Exterior unit x1

8. Interior lock cylinder
cover x1

9. Anchor screw x4

10. Interior lock cylinder
cover base x1

11. Anchor screw for lock
cylinder x1

12. Exterior lock cylinder
cover x1

13. Lock cylinder x1

Notice before assembling

This product applies to doors with swing directions as follows: left-hand inswing, left-hand outswing, right-hand inswing, and right-hand outswing.

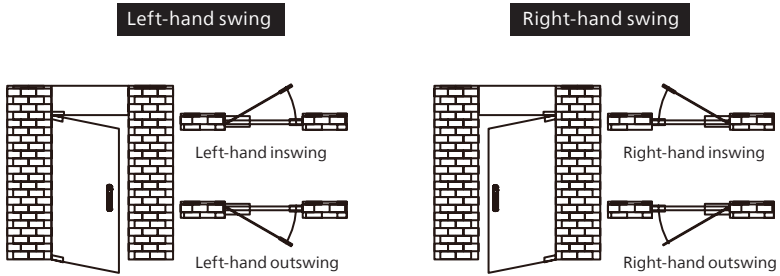

Adjustable latch instructions

Adjust the latch bolt direction based on the needs of inswing and outswing doors.

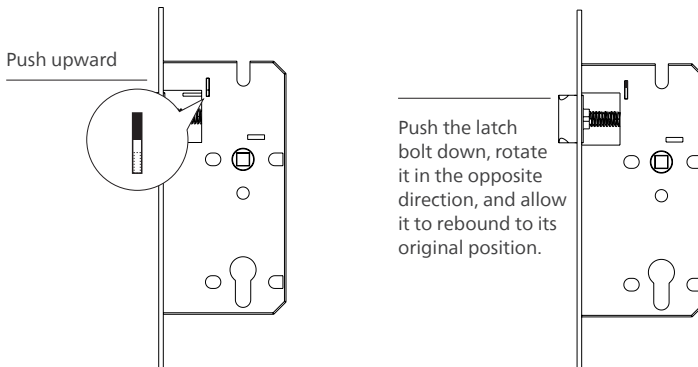

⚠ Attention

The installation kit provided is applicable for doors with a thickness of 35-60mm. If your door thickness falls outside this range, please consult our local dealer for further assistance.

Assembly procedures

The following assembly instructions are for right-hand swing doors. For left-hand swing doors, please read and understand the 'Notice before assembling' section, and follow the 'Adjustable latch instructions' to adjust the latch bolt direction accordingly.

- 1 Drill holes according to the drilling template, then place the mortise inside the frame and use the two anchor screws to secure the mortise.

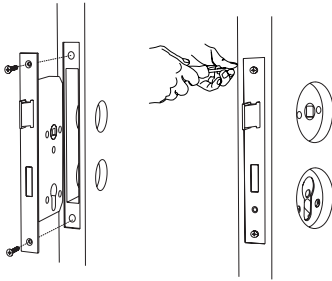

⚠ Attention

During installation, the deadbolt should not be protruding or extending out.

- 2 Align the hollow square shaft on the exterior unit with the rotating opening on the mortise. Align the exterior lock cylinder cover with the lock cylinder, ensuring that the exterior unit and the exterior lock cylinder cover are tightly attached to the outside of the door.

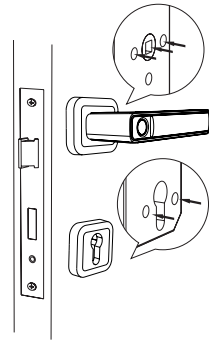

- 3 Place the interior unit base firmly against the inside of the door and secure it with two screws. Similarly, align the base of the interior lock cylinder cover against the inside of the door and secure it with two screws.

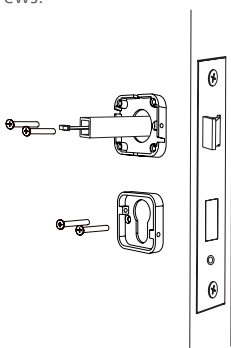

- 4 Refer to the diagram for instructions on opening the battery cover.

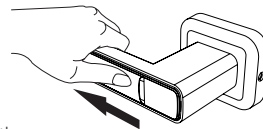

Push the cover as indicated by arrow

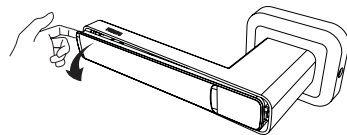

- 5 Connect the cable to the interior unit. Then assemble the interior unit and the interior lock cylinder cover. Use the provided screws to secure the interior unit and the interior decorative ring on both sides.

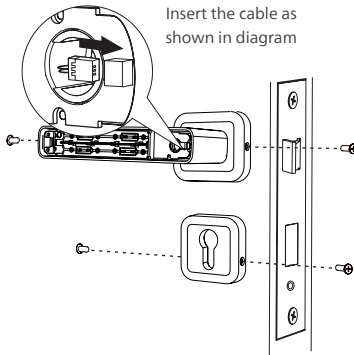

- 6 Insert the lock cylinder and secure it with the screw as shown in the diagram.

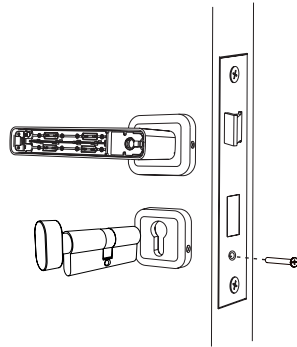

- 7 Install the battery, close the battery cover, and attach the strike plate to complete the assembly process.

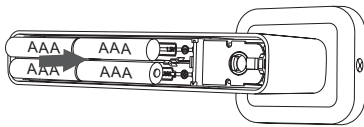

⚠ Attention

After installing the strike plate, please ensure the door opens and closes smoothly.

- 8 Verify that the lock cylinder, thumb turn and mechanical key are functioning properly and ensure that all components are securely connected.

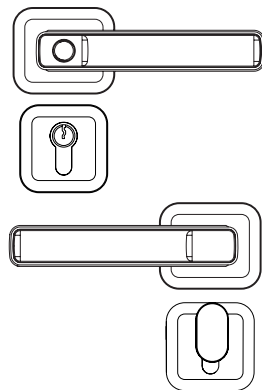

3 Get to know your lock

This packing list is for reference only. Please refer to the actual packing items.

Exterior unit

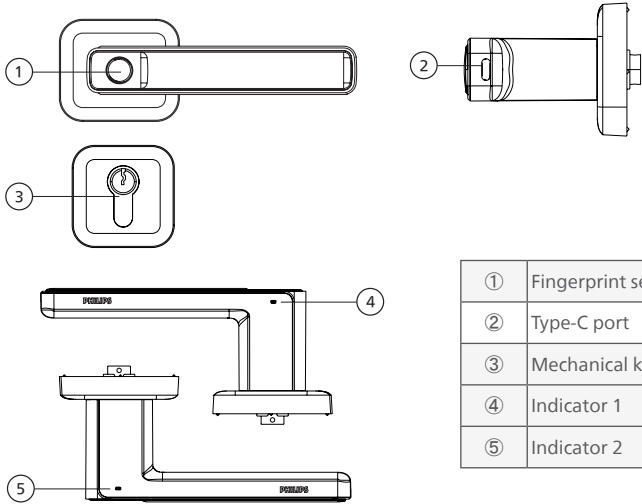

①	Fingerprint sensor
②	Type-C port
③	Mechanical keyhole
④	Indicator 1
⑤	Indicator 2

Interior unit

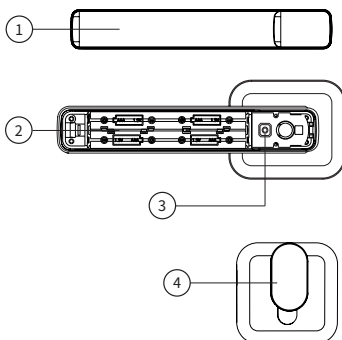

①	Battery cover
②	Battery compartment
③	Setup button
④	Thumb turn

4 Settings

Initialization

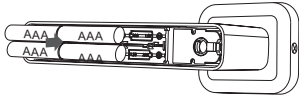

After inserting the batteries into the lock, perform the initialization procedure and engage self-checking for locking the door.



Indicator: blue light on for 2s
Buzzer: one "Beep" sound

Fingerprint



It supports the enrollment of up to 45 fingerprints, including 1 master fingerprint and 44 user fingerprints.

Master fingerprint

The first enrolled fingerprint will be automatically set as the master fingerprint, which allows you to perform operations such as adding user fingerprints and unlocking the door.

Add a master fingerprint

Prerequisite: With batteries installed and the device in its default factory state.

- ① Press the setup button once. You will hear a "beep" sound from the buzzer, and the blue light will stay continuously lit, indicating that the device has entered the setup mode.

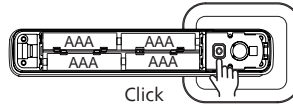

LED in blue and  emits a long "beep" sound

- ② Press the finger that needs to be enrolled as the master fingerprint on the fingerprint sensor for 8 times. During the first 7 presses, the buzzer will emit a short "beep" sound and the blue light will flash twice. On the 8th press, the buzzer will emit two "beep" sound and the indicator will flash green twice, indicating successful enrollment and automatic exit. If the enrollment fails, the indicator will flash red twice and the buzzer will emit three "beep" sound.

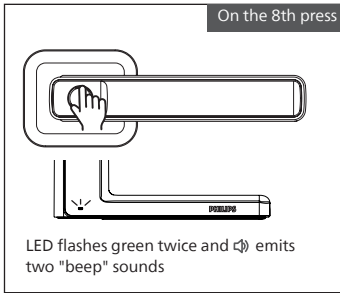
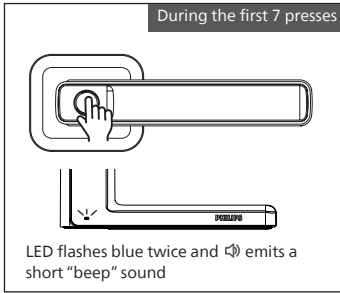

⚠ Attention

1. Unable to enter the setup mode using user fingerprint.
2. Enrolled fingerprints cannot be registered for a second time.
3. In setup mode, if there is no operation for more than 10 seconds, the buzzer emits a single "beep" sound, the red light stays on for 2 seconds, and the system automatically exits the setup mode.

User fingerprint

User fingerprints can be used for daily unlocking and remain valid permanently unless the system is restored to default settings.

Add a user fingerprint

User fingerprints can be used for daily unlocking and remain valid permanently unless the system is restored to default settings.

Prerequisite: Before adding user fingerprints, you need to successfully enroll a master fingerprint.

- ① Press the setup button, the buzzer will emit a "beep" sound, and the blue light will stay on continuously, indicating that the device has entered the setup mode.

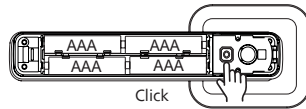

LED in blue and 🔊 emits a long "beep" sound

- ② After enrolling a successful master fingerprint, use the enrolled master fingerprint for verification. When the master fingerprint is successfully verified, the buzzer will emit a "beep" sound, and the blue light will stay on. If the master fingerprint verification fails, the indicator will flash red twice, and the buzzer will emit three "beep" sound.

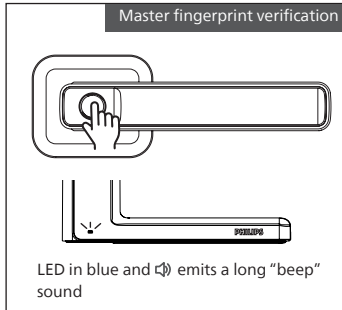

- ③ Press the finger that needs to be enrolled on the fingerprint sensor for 8 times. During the first 7 presses, the buzzer will emit a short "beep" sound and the blue light will flash twice. On the 8th press, the buzzer will emit two "beep" sound and the indicator will flash green twice, indicating successful enrollment and automatic exit. If the enrollment fails, the indicator will flash red twice and the buzzer will emit three "beep" sound.

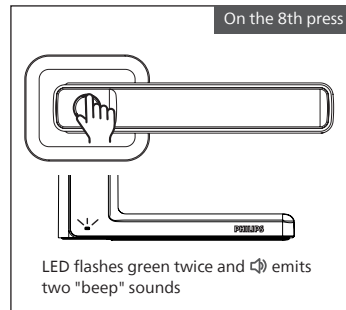
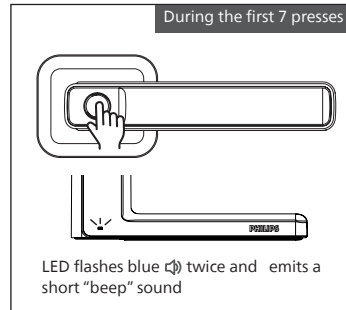

⚠ Attention

1. Non-master fingerprint is unable to access the setting mode.
2. Registered fingerprint cannot be enrolled again.
3. In the setting mode, no user interaction for more than 10 seconds will trigger a "beep" sound, a 2-second red light, and the system will automatically exit the setting mode.

Lock mode

General mode

After adding fingerprints to the lock, the lock will enter the general mode, where the door requires a fingerprint to unlock after being locked. When a fingerprint is successfully verified, the motor will activate the clutch to unlock the door. After 5 seconds, the lock will automatically engage (the clutch will disengage), making it impossible to unlock using the handle.

Passage mode

Enable passage mode

① Press the setting button located in the interior unit. The buzzer emits a "beep" sound, and the blue light remains steady, indicating that you are entering the setting mode.

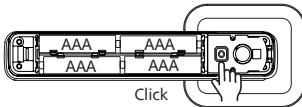

LED in blue and  emits a long "beep" sound

② Re-clicking the setting button will cause the green light to flash twice, and the buzzer will emit two "beep" sounds, indicating that the passage mode is activated.

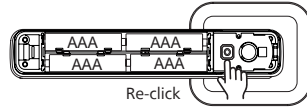

LED flashes green  twice and emits a long "beep" sound

Disable passage mode

① When the passage mode is enabled, clicking the setting button located in the interior unit will emit a "beep" sound from the buzzer, and the blue light will remain steady, indicating that you are entering the setting mode. To disable the passage mode, click the setting button again. The green light will flash twice, and the buzzer will emit two "beep" sounds.

② In the passage mode, any registered fingerprint verification will automatically disable the passage mode.

Exhibition Mode

In the default settings, before adding any fingerprints, the lock can be unlocked with any finger.

Mute mode

Enable mute mode

Prerequisite: Non-setting mode + Mute mode disabled

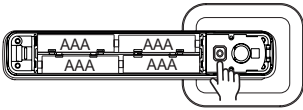

Double-click the setting button within 0.5s



LED flashes green twice and emits two "beep" sounds

Mute mode disabled

Prerequisite: Non-setting mode + Mute mode enabled

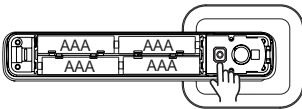

Double-click the setting button within 0.5s



LED flashes green twice and emits two "beep" sounds

Restore to default settings

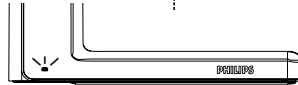
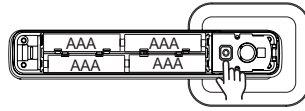

LED in blue and emits a long "beep" sound

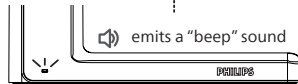

emits a "beep" sound

Press the setting button for 5 seconds, the buzzer will emit a "beep" sound, and the blue light will stay on, and this will initiate a factory reset. After deleting the master and user fingerprints, it will restore to exhibition mode, and the buzzer will emit two "beep" sounds.

Attention

After restoring the lock to default settings, the master fingerprint and user fingerprints will be deleted. Please proceed with caution.

Application binding

① Download

Please scan the QR code below or search for "Tuya Smart" in the app store to download the App.



② Add a door lock (after adding the admin)

1. On the homepage, tap the "+" icon in the top right corner, then select "Add a device".
2. Choose the "Camera/Lock" category on the left side, and select "Door Lock (Bluetooth)". Tap to enter the next interface.
3. Enter the settings mode and verify the master fingerprint.

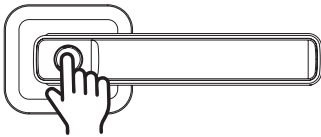

4. Select "Enable Bluetooth Pairing" and click Next.
5. The discovered devices will be listed in the search interface.
6. Tap the "+" button on the right to add the lock.

7. After adding the lock, a new interface will prompt you to rename the newly paired lock.
8. Tap the "Done" button in the top right corner, and the app will automatically enter the main interface for the lock.

⚠ Attention

1. Keep the Bluetooth function on your phone enabled.
2. Make sure to keep your phone near the door lock during the lock adding process to ensure a successful connection within the Bluetooth range.

5 Get to use your lock

Outdoor/ indoor unlock

Outdoor unlock

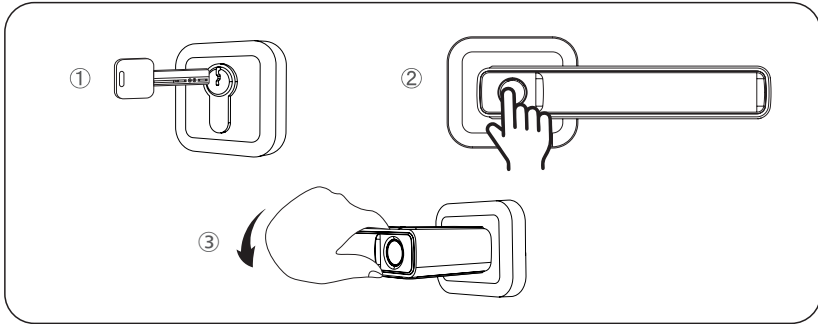

After successful fingerprint verification, the motor activates the clutch to unlock, allowing you to press down the handle and open the door (If the door is locked from the inside, please insert the key into the keyway to unlock it before verifying the fingerprint).

Indoor unlock

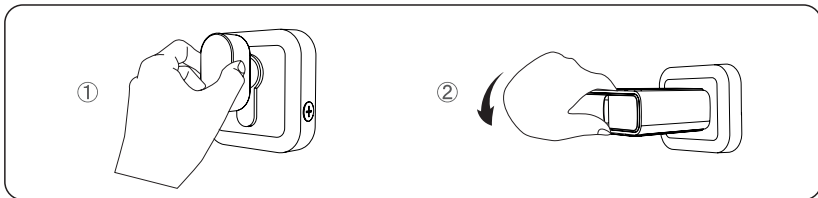

You are allowed to press down the handle and open the door (If the door is locked from the inside, please rotate the thumb turn to unlock it).

Outdoor/ indoor locking

Auto-locking will occur after 5 seconds of unlocking (the clutch will automatically disengage, making it impossible to unlock with the handle).

6 Indicator explanation



Blue: System wake-up

Green: Verification succeeded

Red: Verification failed

7 Troubleshooting

Low battery alert

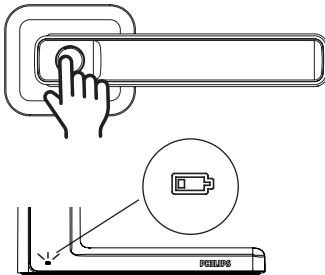

Unlocking: The green light flashes twice, accompanied by two "beep" sounds.

Alert : The red light flashes five times, accompanied by six "beep" sounds.

Triggering: Upon system wake-up, the battery voltage is automatically checked.

If the battery voltage is low, an alert will sound after unlocking, reminding you to replace the battery promptly.

Alert type: The buzzer emits six "beep" sounds, and the indicator light flashes red five times.

Lock-out alert

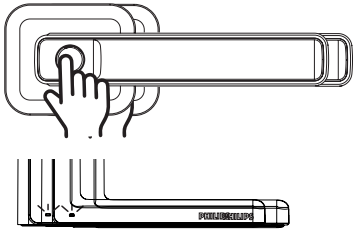

Red light flashes 5 times and emits 6 "beep" sounds).

If 5 consecutive incorrect fingerprints are entered within 5 minutes, the system will lock for 3 minutes.

Status indication: Red light flashes 5 times and emits 6 "beep" sounds during each verification, with the timer restarting.

Alarm release: Automatically released after 3 minutes.

Battery replacement

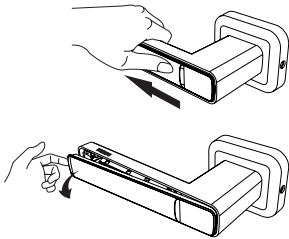

The lock is powered by 4 AAA batteries. The battery compartment is located inside the interior unit. Push and pry open the battery cover from the end of the handle to replace the batteries.

How to apply an external power supply

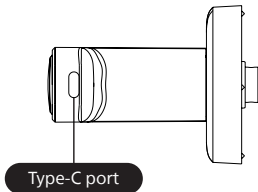

If the battery voltage is insufficient to unlock the door from the outside, you can use a 5V power bank as an external power supply by connecting it to the lock via the Type-C port. After unlocking the door, please replace the batteries promptly.

If the system freezes and you cannot unlock the door from the outside, you can use a 5V power bank to power the lock. This will automatically restart the system.



Philips and the Philips Shield Emblem are registered trademarks of Koninklijke Philips N.V. and are used under license. This product has been manufactured by and is sold under the responsibility of Shenzhen Conex Intelligent Technology Co., Ltd. and Shenzhen Conex Intelligent Technology Co., Ltd. is the warrantor concerning this product.